



1908/371 Little Lonsdale Street Melbourne VIC

2 2

380 Melbourne elevates style, amenities and convenience to luxurious new heights. The unique interior and finish of this residential apartment with its clean lines, flowing spaces and sophisticated palette, has been inspired by the architecture of Elenberg Fraser. Perfectly situated in the retail heart of the CBD, with some of Melbourne's finest restaurants & cafes at your doorstep, with easy access to universities and public transport

View : <https://www.bradyresidential.com.au/lease/vic/inner-city/melbourne/residential/apartment/8079060>

Situated in the absolute heart of the CBD, this apartment features:

- Stylish and sleek kitchen with Miele appliances
- Spacious living area
- Two bedrooms with built in robes
- Two modern bathrooms with high-end finishes
- European laundry
- Heating and cooling (living area & bedrooms)



Tom Prior
9603 1400



Emma Luo
03 9603 1400

APARTMENT: 1908

2 Bedroom & 2 Bathroom
Apartment Type C5
AREA: 69.2 m²

Bay 1 (5)

Bay 2 (1)

Bay 3 (3)

Bay 4 (8)

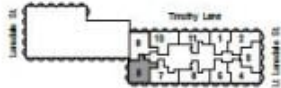

INDIVIDUAL APARTMENT PLAN

Plans are indicative and may be varied in accordance with Contract of Sale. Furniture depicted is not included. Refer to the Contract of Sale for included fixtures & fittings. Areas are calculated using the Property Council of Australia's Method of Measurement for Residential Property.

Revision: A Updated: 99992017

BRADY