



607/604 Swanston Street CARLTON VIC

2  1  1 

Taking in views of elegantly landscaped Lincoln Square garden and lofty city skyscrapers, this two bedroom 'Seasons' apartment offers a winning convergence of lifestyle and convenience in one of Melbourne's most desirable locales. Open design leads past a kitchen, meals and living zone through a floor-to-ceiling glass aspect to a covered balcony with winning views. Stainless steel Smeg appliances and a pull-out pantry feature in the kitchen, and you'll also find built-in robes, a secure entrance with intercom, elevator access and basement parking space. The convenience of the position is supreme: it's just a stroll to trams, universities, Lygon Street and the CBD.

Type : Apartment

View : <https://www.bradyresidential.com.au/sale/vic/inner-city/carlton/residential/apartment/7416029>

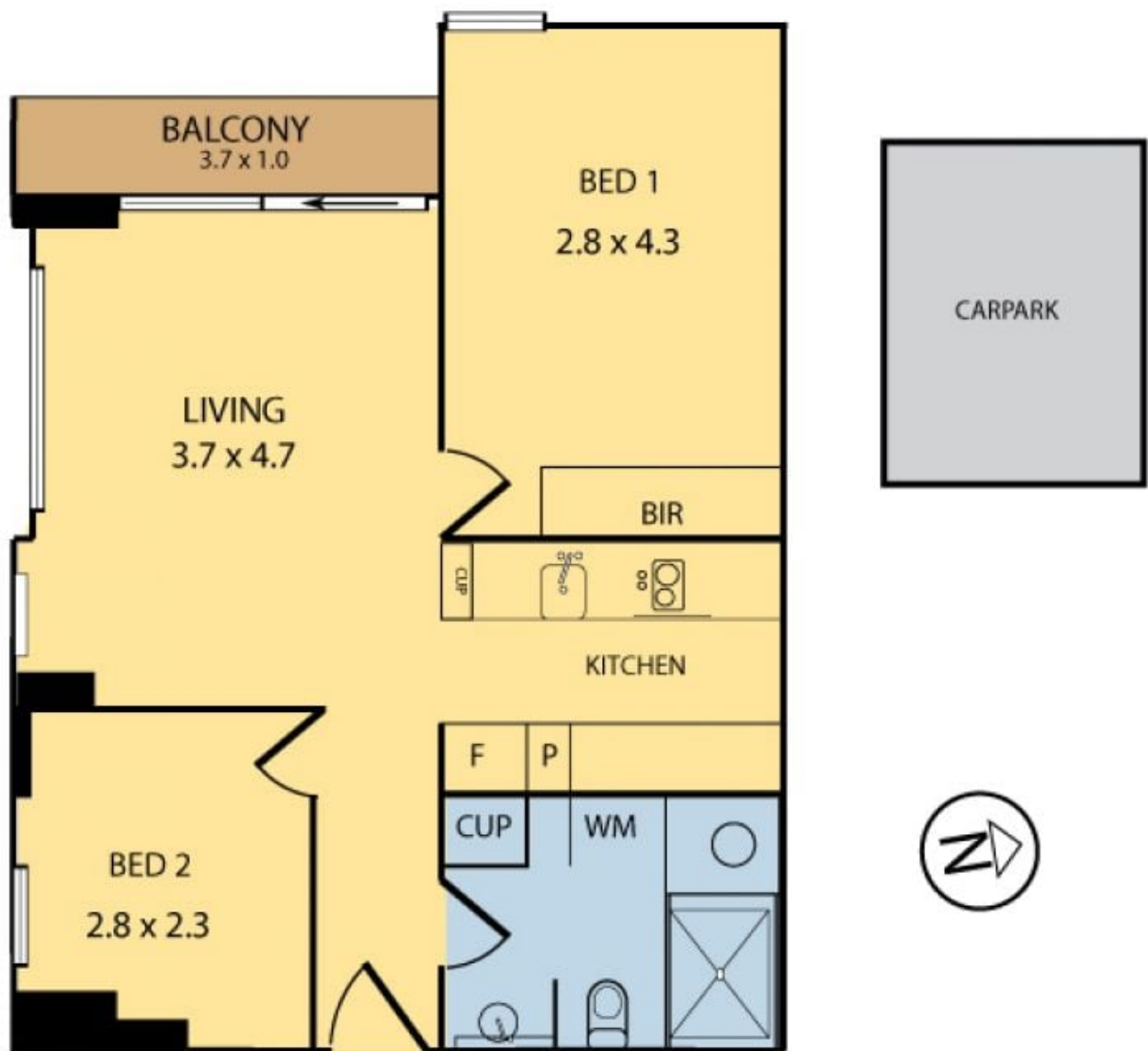

TOTAL APPROX SIZE: 59 sqm

607 / 604 SWANSTON STREET, CARLTON

BRADY residential

Please note: All stated dimensions are approximate only. Particulars given are for general information only and do not constitute any representation on the part of the vendor and agent.