

270 King Street MELBOURNE VIC

2 1

Positioned in the highly sought after building of 270 King Street, this large two bedroom apartment is situated on the 11th floor and is perfect for first home buyers or savvy investors. The apartment features a large, bright living area which leads on to a east facing balcony, a fully equipped kitchen with granite work tops and dishwasher. Two equally large sized bedrooms (both with BIR's) and a sizable family bathroom with European laundry. Video security intercom and reverse cycle air conditioning, add extra bonus to this already impressive apartment. Also available for your enjoyment are the buildings superb recreation facilities including a large lap pool, spa and gymnasium and is only a short walk to Southern Cross Station, Flagstaff Gardens and the Crown Casino Complex. Inspect now before it's too late!

[For full version visit the website](https://www.bradypressidential.com.au/sale/vic/inne-r-city/melbourne/residential/unit/7415605)

Type : Unit

View : <https://www.bradypressidential.com.au/sale/vic/inne-r-city/melbourne/residential/unit/7415605>

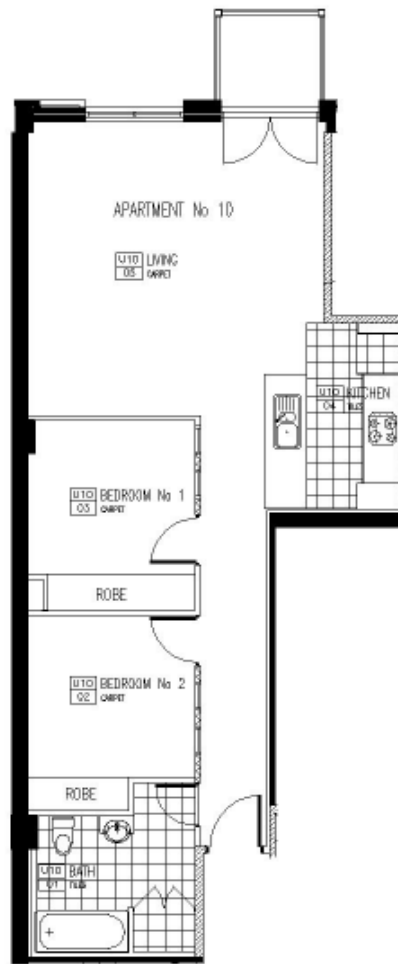

BRADY
 Residential Development
 Projected Apartment and Units
 12 Street Building
 City and County of Denver
 Typical Floor Plan
 Apartment Location
 Apartment No 10